

Model 59124

### 3-IN-1 Metal ,Live Wire And Stud Detector

|   |   |
|---|---|
|  | <ol style="list-style-type: none"><li>1. ON/OFF Button.</li><li>2. Mode selector switch.</li><li>3. LCD display.</li><li>4. AC indicator.</li></ol>   |
|   | <p><b>POWER SUPPLY</b><br/>The tools require one 9 volt battery to operate.</p> <p><b>BATTERY INSTALLATION</b></p> <ol style="list-style-type: none"><li>1. Open battery door on back of case.</li><li>2. Connect a 9-volt battery to battery clip.</li><li>3. Insert battery into case and replace battery door.</li></ol> |

|  |  |
|--|--|
|  | <p><b>Turning the power on/off</b></p> <p>On : Press and hold the on/off button on left side.</p> <p>Off :Release on/off button.</p>   |
|   | <p><b>Stud Scan or Deep Scan modes</b></p> <p>Stud Scan mode for depths to about 3/4 in. (18mm).</p> <p>Deep Scan mode for Depths to about 11/2 in(30mm).</p> <p>Position the Scanner Flat against the Wall. Select mode. Press and hold on/off button.</p> <p>Sounds off the auto finish.</p> |
|  | <p>Slowly slide unit horizontally across wall, right of left.</p> <p>When full bars appears on the LCD and steady tone sounds, you have located the edge of the stud. Mark this spot.</p> <p>Continue holding on/off button in and scan beyond the marked spot until bars disappears.</p>      |

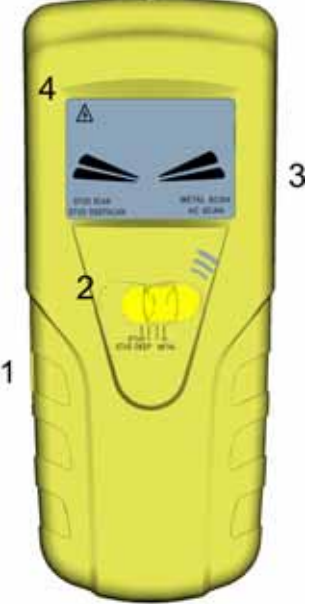
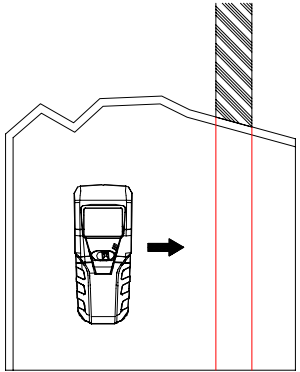
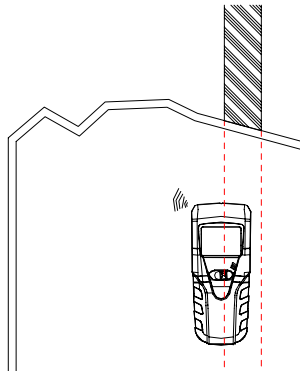
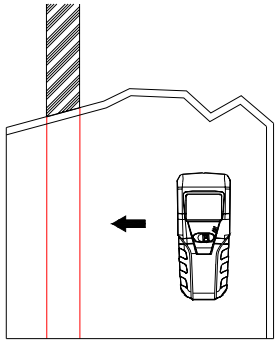

Without releasing on/off button, slide scanner in reverse direction to locate the other edge of stud. Mark this second spot. Middle of stud is centered between the two marks.

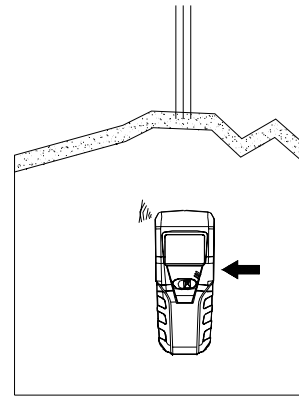

Continue scanning beyond the marked spot to detect width of target. If target is wide, reverse to locate and mark the other edge. Avoid sawing or drilling between the two marks. Widths will vary from single peak for narrow rebar to wide area for metal studs, I beams, junction boxes.

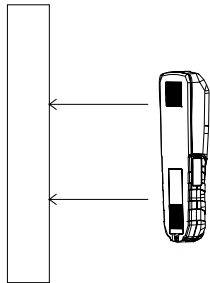

**Calibrating and Scanning in metal Scan.**

Select metal mode. Press and hold on/off button. Then calibrate scanner in air. Away from metal objects, until the sounds off. Place scanner flat on the surface.

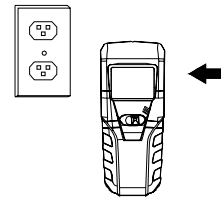

**Scanning in AC mode**

AC depths to about 2 in. Select AC scan mode to determine position of hot wires. Begin by placing the scanner at some position away from hot wiring.

While holding in the on/off button, slowly slide unit across the wall. AC indicator will appear on LCD if a hot wire is nearby. LCD display indicates proximity to hot wire all bars indicating closest proximity. Mark this mark.

The scanner detects from 90V to 250 V at 50 to 60 Hz AC in a HOT electrical wire. The voltage detection feature works continuously in all modes for safety.

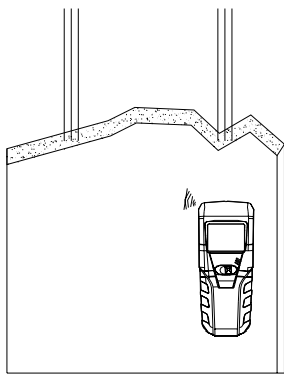

While holding in on/off button, slowly move unit randomly to locate target LCD screen indicates proximity to metal, with center bar indicating closest proximity. Mark this spot.