

Flex Cable Long Barrel 2 Hole Compression Lugs

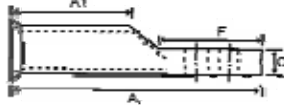
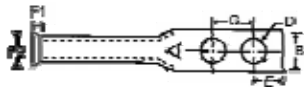

- ▶ High Conductivity Seamless Copper
- ▶ Electro-Tin Plating Resists Corrosion, reduces Contact Resistance for Maximum Conductivity
- ▶ Flared/Belled Entry for Easy Insertion of Fine Strand Flexible Cable - Class G, H, I, K(Battery), M(Welding), DLO
- ▶ Color Coded Die Index and Crimp Marks Printed on Barrel
- ▶ UL 486A Listed for Applications Thru 35KV

New! Available January 2015

Dimensions = Inches

Cat. No.	Wire Range	Stud Size	Hole Space	Color Code	COMM	ASTM Class H	Welding Class M	DLO	A	A1	B	C	D	E	F	G	F1	F2	Box Qty
94702	8	1/4	5/8	Red	8	10	10	-	2.19	.81	.42	.08	.25	.28	1.26	.63	.12	.32	50
94703	6	1/4	5/8	Blue	6	8	8	(61)	2.36	.98	.42	.08	.25	.28	1.26	.63	.16	.34	50
94705	6	1/4	3/4	Blue	6	8	8	(61)	2.48	.98	.42	.08	.25	.28	1.38	.75	.16	.34	50
94706	6	3/8	1	Blue	6	8	8	(61)	2.91	.98	.42	.08	.41	.38	1.81	1.00	.16	.34	50
94707	6	1/2	1-3/4	Blue	6	8	8	(61)	4.09	.98	.87	.12	.51	.62	2.99	1.75	.16	.34	50
94708	4	1/4	5/8	Gray	4	6	6	(105)	2.36	.98	.49	.09	.25	.28	1.26	.63	.16	.42	50
94709	4	1/4	3/4	Gray	4	6	6	(105)	2.52	.98	.49	.09	.25	.28	1.38	.75	.16	.42	50
94710	4	3/8	1	Gray	4	6	6	(105)	2.95	.98	.42	.09	.41	.38	1.81	1.00	.16	.42	50
94711	4	1/2	1-3/4	Gray	4	6	6	(105)	4.09	.98	.87	.12	.51	.62	2.99	1.75	.16	.42	50
94712	2	1/4	5/8	Brown	2	4	4	(125)	2.52	1.10	.60	.10	.25	.28	1.26	.63	.18	.40	25
94713	2	1/4	3/4	Brown	2	4	4	(125)	2.64	1.10	.60	.10	.25	.28	1.38	.75	.18	.40	25
94716	2	3/8	1	Brown	2	4	4	(125)	3.07	1.10	.60	.10	.41	.38	1.81	1.00	.18	.40	25
94717	2	1/2	1-3/4	Brown	2	4	4	(125)	4.25	1.10	.81	.10	.51	.62	2.99	1.75	.18	.40	25
94718	1	1/4	5/8	Green	1	2	2	(150)	2.56	1.10	.67	.11	.25	.28	1.26	.63	.18	.53	25
94719	1	1/4	3/4	Green	1	2	2	(150)	2.68	1.10	.67	.11	.25	.28	1.38	.75	.18	.53	25
94721	1	3/8	1	Green	1	2	2	(150)	3.07	1.10	.67	.11	.41	.38	1.81	1.00	.18	.53	25
94722	1	1/2	1-3/4	Green	1	2	2	(150)	4.29	1.10	.75	.10	.51	.62	2.99	1.75	.18	.53	25
94725	1/0	1/2	1-3/4	Pink	1/0	1	1	(225)	4.63	1.20	.74	.12	.51	.62	2.99	1.75	.18	.56	10
94726	2/0	1/4	3/4	Black	2/0	1/0	1/0	1/0(275)	2.99	1.38	.81	.12	.25	.28	1.38	.75	.24	.64	10
94727	2/0	3/8	1	Black	2/0	1/0	1/0	1/0(275)	3.43	1.38	.81	.12	.41	.38	1.81	1.00	.24	.64	10
94728	2/0	1/2	1-3/4	Black	2/0	1/0	1/0	1/0(275)	4.61	1.38	.81	.12	.51	.62	2.99	1.75	.24	.64	10
94730	3/0	3/8	1	Orange	3/0	2/0	-	2/0(325)	3.50	1.38	.90	.13	.41	.38	1.81	1.00	.24	.72	10
94732	3/0	1/2	1-3/4	Orange	3/0	2/0	-	2/0(325)	4.65	1.38	.90	.13	.51	.62	2.99	1.75	.24	.72	10
94733	4/0	3/8	1	Purple	4/0	3/0	2/0	3/0(450)	3.54	1.42	1.00	.13	.41	.38	1.81	1.00	.26	.77	10
94734	4/0	1/2	1-3/4	Purple	4/0	3/0	2/0	3/0(450)	4.72	1.42	1.00	.13	.51	.62	2.99	1.75	.26	.77	10
94735	250	3/8	1	Yellow	250	-	3/0	4/0(550)	3.78	1.61	1.09	.15	.41	.38	1.81	1.00	.28	.80	10
94736	250	1/2	1-3/4	Yellow	250	-	3/0	4/0(550)	4.96	1.61	1.09	.15	.51	.62	2.99	1.75	.28	.80	10
94737	300	1/2	1-3/4	White	300	4/0	4/0	262.6	5.31	1.97	1.19	.15	.51	.62	2.99	1.75	.31	.84	10
94738	350	3/8	1	Red	350	250	250	313.1	4.21	1.97	1.28	.17	.41	.38	1.81	1.00	.31	.94	10
94739	350	1/2	1-3/4	Red	350	250	250	313.1	5.39	1.97	1.28	.17	.51	.62	2.99	1.75	.31	.94	10
94740	400	1/2	1-3/4	Blue	400	300	300	350	5.47	1.97	1.39	.18	.51	.62	2.99	1.75	.33	1.08	10
94741	500	3/8	1	Brown	500	350	350	373.3	4.57	2.24	1.54	.22	.41	.38	1.81	1.00	.35	1.20	10
94742	500	1/2	1-3/4	Brown	500	350	350	373.3	5.75	2.24	1.54	.22	.51	.62	2.99	1.75	.35	1.20	10
94744	600	1/2	1-3/4	Green	600	400	400	444.4	5.79	2.24	1.72	.25	.51	.62	2.99	1.75	.39	1.34	6
94746	750	1/2	1-3/4	Black	750	600	500	-	6.30	2.64	1.90	.27	.51	.62	2.99	1.75	.43	1.47	3

Flex Cable Short Barrel Compression Splices



New! Available January 2015

Dimensions = Inches



Cat. No.	Conductor Range	Color Code	COMM	ASTM Class H	Welding Class M	DLO	Length (A)	F1	F2	Box Qty
94750	8	Red	8	10	10	-	.90	.12	.32	50
94751	6	Blue	6	8	8	(61)	1.00	.16	.34	50
94752	4	Gray	4	6	6	(105)	1.00	.16	.42	50
94753	2	Brown	2	4	4	(125)	1.25	.18	.19	25
94754	1	Green	1	2	2	(150)	1.80	.18	.53	25
94755	1/0	Pink	1/0	1	1	(225)	1.60	.18	.56	10
94756	2/0	Black	2/0	1/0	1/0	1/0(275)	1.75	.24	.64	10
94757	3/0	Orange	3/0	2/0	-	2/0(325)	1.75	.24	.72	10
94758	4/0	Purple	4/0	3/0	2/0	3/0(450)	1.90	.26	.77	10
94759	250	Yellow	250	-	3/0	4/0(550)	2.00	.26	.84	10
94760	300	White	300	4/0	4/0	262.6	2.10	.31	.94	10
94761	350	Red	350	250	250	313.1	2.10	.33	1.02	10