

# Nylon Insulated Spade Terminals



## MAXIMUM ELECTRIC CURRENT:

Awg	22	20	18	16	14	12	10	8	6
Amp	9	12	17	18	30	35	50	70	95

**MAXIMUM ELECTRIC RATING:** 221°F (105°C) 600 Volts

**INSULATION MATERIAL:** Nylon

**TERMINAL MATERIAL:** Electro-Tin Plated Copper - Brazed Seam

**FEATURES:** Serrated Barrel, Expanded Insulation

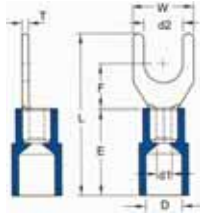

Dimensions = Inches

Cat. No.	Color	Wire Size AWG	Stud Size	d2	W	F	L	E	D	d1	T	Bag Qty	Master Bag Qty
11612	Red	22-16	#4	.126	.224	.256	.866	.433	.157	.067	.030	100	1000
11614	Red	22-16	#6	.146	.252	.256	.866	.433	.157	.067	.030	100	1000
11616	Red	22-16	#8	.169	.319	.256	.866	.433	.157	.067	.030	100	1000
11618	Red	22-16	#10	.209	.319	.256	.866	.433	.157	.067	.030	100	1000
11620	Red	22-16	1/4	.252	.472	.433	1.102	.433	.177	.091	.031	100	1000
11622	Blue	16-14	#4	.126	.224	.256	.866	.433	.177	.091	.031	100	1000
11624	Blue	16-14	#6	.146	.283	.256	.866	.433	.177	.091	.031	100	1000
11626	Blue	16-14	#8	.169	.311	.256	.866	.433	.177	.091	.031	100	1000
11628	Blue	16-14	#10	.209	.366	.256	.866	.433	.177	.091	.031	100	1000
11630	Blue	16-14	1/4	.252	.472	.433	1.102	.433	.177	.091	.031	100	1000
11632	Yellow	12-10	#6	.146	.327	.276	1.004	.512	.252	.134	.039	100	1000
11634	Yellow	12-10	#8	.169	.327	.276	1.004	.512	.252	.134	.039	100	1000
11636	Yellow	12-10	#10	.209	.354	.276	1.004	.512	.252	.134	.039	100	1000
11638	Yellow	12-10	1/4	.252	.472	.472	1.240	.512	.252	.134	.039	100	1000
11640	Yellow	12-10	5/16	.331	.551	.413	1.201	.512	.252	.134	.039	100	1000
11642	Red	8	#10	.209	.413	.319	1.114	.630	.315	.177	.047	100	-
11644	Red	8	1/4	.252	.425	.339	1.181	.630	.315	.177	.047	100	-
11646	Blue	6	1/4	.252	.433	.421	1.437	.846	.433	.228	.059	100	-
11648	Blue	6	5/16	.331	.543	.421	1.555	.846	.433	.228	.059	100	-

Fork/Spade Terminals

H12

# Non-Insulated Locking Spade Terminals



## MAXIMUM ELECTRIC CURRENT:

Awg	22	20	18	16	14	12	10	8	6
Amp	9	12	17	18	30	35	50	70	95

**MAXIMUM ELECTRIC RATING:** 302°F(150°C) 600V

**TERMINAL MATERIAL:** Electro-Tin Plated Copper - Brazed Seam

**FEATURES:** Serrated Barrel

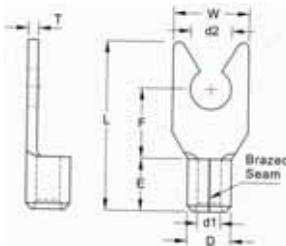

Dimensions = Inches

Cat. No.	Wire Size AWG	Stud Size	d2	W	F	L	E	D	d1	T	Bag Qty	Master Bag Qty
11662	22-16	#6	.146	.252	.256	.630	.189	.134	.067	.030	100	1000
11664	22-16	#8	.169	.319	.256	.630	.189	.134	.067	.030	100	1000
11666	22-16	#10	.209	.319	.256	.630	.189	.134	.067	.030	100	1000
11668	16-14	#6	.146	.236	.256	.630	.189	.161	.091	.031	100	1000
11670	16-14	#8	.169	.319	.256	.630	.189	.161	.091	.031	100	1000
11672	16-14	#10	.209	.366	.256	.630	.189	.161	.091	.031	100	1000
11674	12-10	#6	.146	.327	.276	.717	.236	.220	.134	.039	100	1000
11676	12-10	#8	.169	.327	.276	.717	.236	.220	.134	.039	100	1000
11678	12-10	#10	.209	.354	.276	.717	.236	.220	.134	.039	100	1000
11680	12-10	1/4	.252	.472	.472	.965	.236	.220	.134	.039	100	1000