

Rigid to Rigid Pull Elbows - Zinc Die Cast

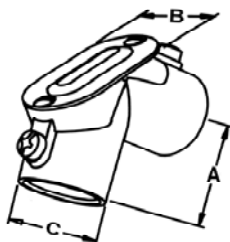

- ▶ For use as a Wire Pulling Elbow to Facilitate Wire Pulling on a Sharp Bend in run of Threaded Rigid or IMC Conduit
- ▶ Removable Cover allows easy access to facilitate wire pulling
- ▶ Furnished with Neoprene Gasket and Cover
- ▶ Rain Tight



Dimensions = Inches

Cat. No.	Trade Size	Dimensions			Outer Box
		A	B	C	
14400	1/2"	1.34	1.03	.97	100
14401	3/4"	1.40	1.30	1.23	50
14402	1"	1.97	1.55	1.51	30
14403	1-1/4"	2.32	1.90	1.91	20

Rigid to Box Pull Elbows - Zinc Die Cast



- ▶ For Connecting Threaded Rigid Conduit or IMC to Box or Enclosures to Form 90° bend.
- ▶ Removable Cover allows easy access to Facilitate Wire Pulling
- ▶ Furnished with Neoprene Gasket and Cover
- ▶ Rain Tight

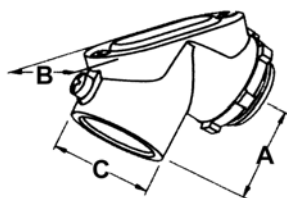

Dimensions = Inches

Cat. No.	Trade Size	Dimensions			Outer Box
		A	B	C	
14404	1/2"	1.34	1.03	.97	100
14405	3/4"	1.40	1.30	1.19	50
14406	1"	1.97	1.55	1.51	30
14407	1-1/4"	2.32	1.90	1.91	20

Straight Malleable Concrete Slab Inserts For Threaded Rigid Conduit

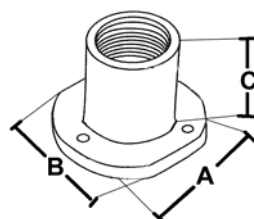

- ▶ Allows In-Slab Ceiling Drops & Floor Mounts in Poured Concrete
- ▶ Provides Flush Threaded Conduit Hub for mounting, pulling, & future access to conduit systems
- ▶ Design allows In-Slab Conduit System Prefabrication
- ▶ Designed for Straight Through Conduit Runs and Mounting of Floor boxes in slabs over 6" thick

Dimensions = Inches

Cat. No.	Trade Size	Dimensions			Outer Box
		A	B	C	
14420	1/2"	1.50	1.75	1.25	20
14421	3/4"	2.72	2.00	1.75	20
14422	1"	2.50	3.25	1.50	10

90° Malleable Concrete Slab Inserts For Threaded Rigid Conduit

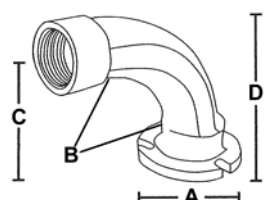

- ▶ Allows In-Slab Ceiling Drops & Floor Mounts in Poured Concrete
- ▶ Provides Flush Threaded Conduit Hub for mounting, pulling, and future access to conduit systems
- ▶ Allows In-Slab Conduit System Prefabrication - Flush Design
- ▶ Designed to Eliminate Bending of conduit in slabs over 4" thick

Dimensions = Inches

Cat. No.	Trade Size	Dimensions				Outer Box
		A	B	C	D	
14423	1/2"	1.50	1.75	3.12	3.62	20
14424	3/4"	2.75	2.00	3.06	3.68	20
14425	1"	2.50	3.75	2.93	3.68	10