



Catalog Number 11910
UPC Number 60198611910
Description Nylon Insulated Female Disconnect Connectors
22-16 AWG

Features

- Nylon Color Coded insulation for easy identification
- Manufactured from high strength copper alloy
- Electro-tin plated for corrosion resistance
- Expanded insulation eliminates strand “Hang Up”, provides strain relief & excellent UV, temperature and chemical resistance
- Wire range stamped on the surface for easy interpretation
- Brazed seams prevent splitting under maximum pressure
- Serrated barrel provides excellent electrical contact & pull-out force resistance

General

Insulation Type Nylon
Material Brass
Finish Electro-Tin Plated
Color Red
Wire Range 22-16
Tab Size .020 X .205

Dimension Information

Stock Thickness 0.014
L Inches (mm) 0.768
B Inches (mm) 0.433
C Inches (mm) 0.067
D Inches (mm) 0.157
F Inches (mm) 0.26
W Inches (mm) 0.224

Specifications

Temperature Rating 105°C
Voltage Rating 300 V
Flammability Rating UL94V-O
Amp Rating 22 AWG 9 Amps
20 AWG 12 Amps
18 AWG 17 Amps
16 AWG 18 Amps

Packaging

Bag Qty 100
Master Bag Qty 1000

Certifications

UL Yes
cUL Yes
RoHS Yes



REV	DESCRIPTION	DATE
-----	-------------	------

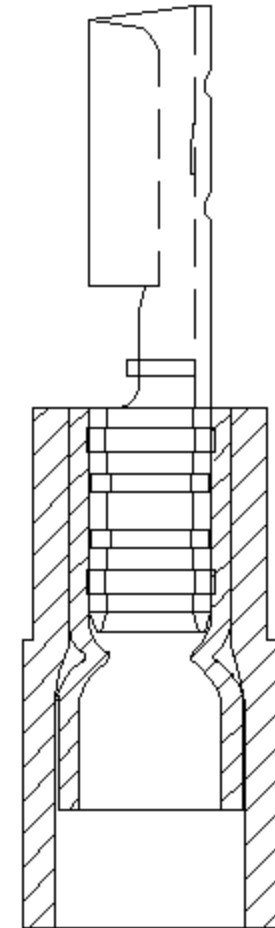
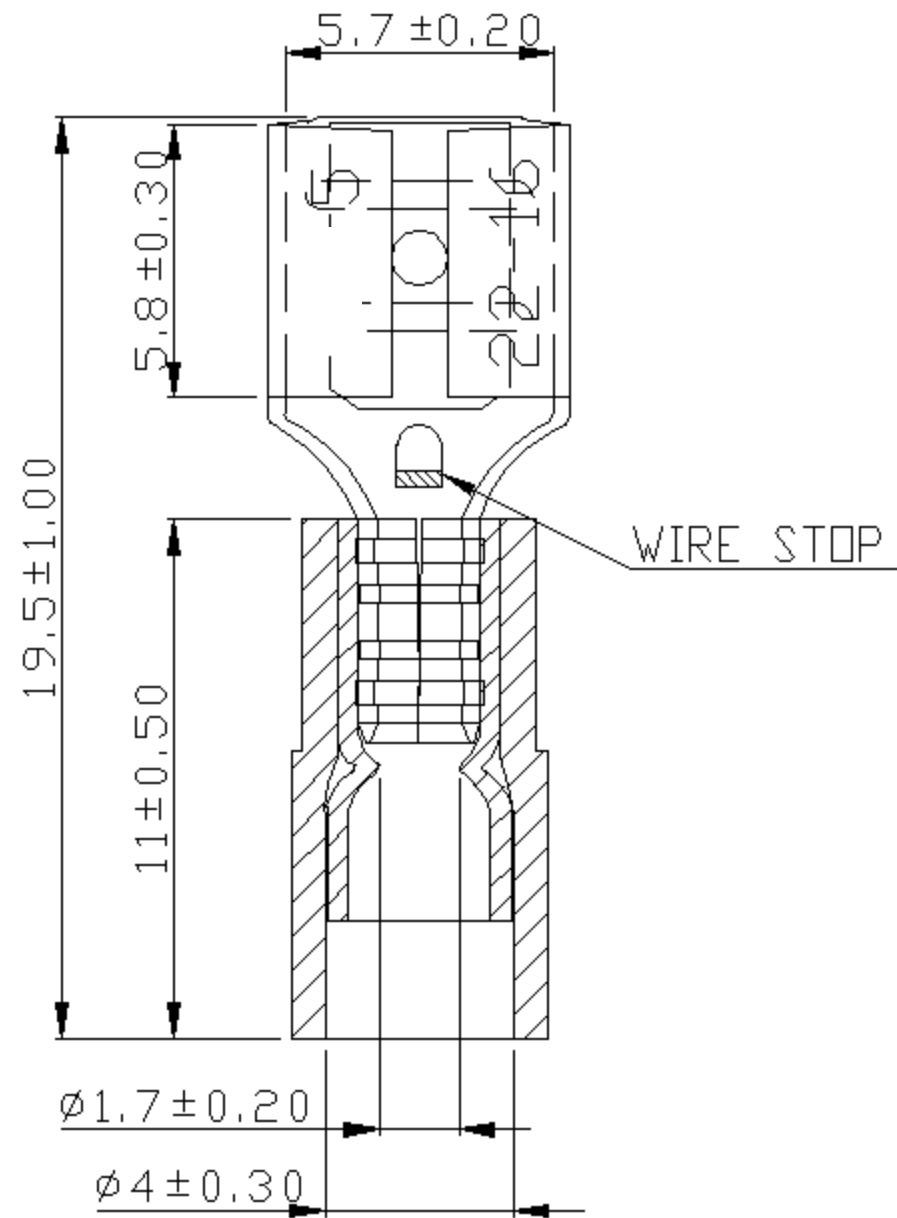
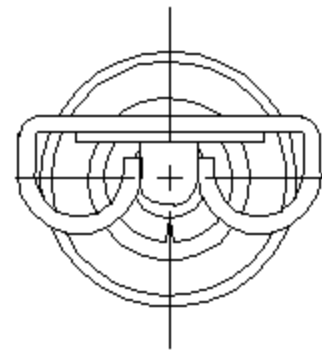

NOTE:

- MAXIMUM ELECTRIC CURRENT :

A.W.G.	22	20	18	16
AMP.	3	4	7	10
- MAXIMUM ELECTRICAL RATING : 105°C 600 VOLTS MAX.
- INSULATION MATERIAL : NYLON
- INSULATION COLOR : RED
- TERMINAL MATERIAL : BRASS
- WIRE RANGE : 22-16 A.W.G.(0.5-1.5 mm²)
- TERMINAL SURFACE TREATMENT : TIN PLATED
- DOUBLE CRIMP : WITH COPPER SLEEVE ON BARREL
- NEMA TAB : 0.020 * 0.205 (0.5 * 5.2)
- TERMINAL THICKNESS : 0.35 mm

Tolerance Unless Otherwise Specified	
0 > 6 mm ± 0.20	ANGLE
6 > 18 mm ± 0.30	0° REF ±
18 > 30 mm ± 0.40	±
30 > 75 mm ± 0.50	±

NAME	NYLON-INSULATED DOUBLE CRIMP FEMALE DISCONNECTORS			UNIT	
PART NO.	11910	MATERIAL	-----	APPROVE	
NUMBER		SCALE	SHEET	PAGE	CHECKED
DATE	2006/09/06	4/1	1-0	10F2	DRAWN

Morris Products Inc.