



**Catalog Number** 11970  
**UPC Number** 60198611970  
**Description** Nylon Fully Insulated Female Disconnect  
 22-16 AWG



### Features

- Nylon Color Coded insulation for easy identification
- Manufactured from high strength copper alloy
- Electro-tin plated for corrosion resistance
- Expanded insulation eliminates strand “Hang Up”, provides strain relief & excellent UV, temperature and chemical resistance
- Wire range stamped on the surface for easy interpretation
- Brazed seams prevent splitting under maximum pressure
- Serrated barrel & extended copper sleeve provides excellent electrical contact & pull-out force resistance.

### General

**Insulation Type** Nylon  
**Material** Brass/Copper  
**Finish** Electro-Tin Plated  
**Color** Red  
**Wire Range** 22-16  
**Tab Size** .250 X .032

### Dimension Information

**Stock Thickness** 0.016  
**L Inches (mm)** 0.846  
**B Inches (mm)** 0.433  
**C Inches (mm)** 0.067  
**D Inches (mm)** 0.157  
**F Inches (mm)** 0.303  
**W Inches (mm)** 0.26

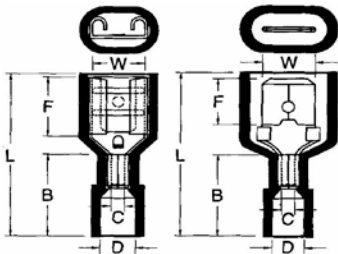

### Specifications

**Temperature Rating** 105°C  
**Voltage Rating** 600 V  
**Flammability Rating** UL94V-O  
**Amp Rating**

22 AWG	3 Amps
20 AWG	4 Amps
18 AWG	7 Amps
16 AWG	10 Amps

### Packaging

**Bag Qty** 100  
**Master Bag Qty** 1000

### Certifications

**UL** Yes  
**cUL** Yes  
**RoHS** Yes



REV	DESCRIPTION	DATE
-----	-------------	------

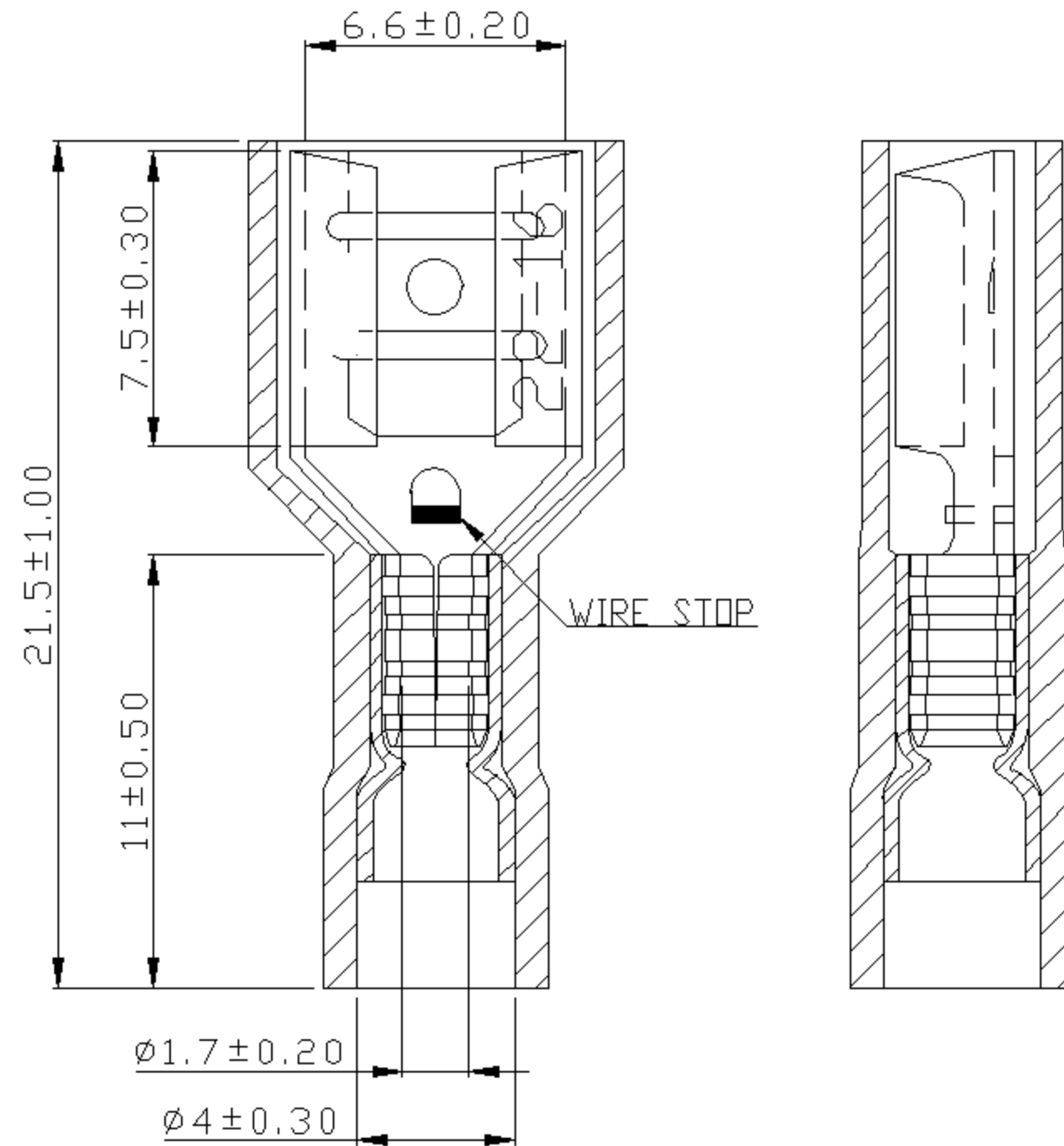

NOTE:

1. MAXIMUM ELECTRIC CURRENT : 

A.W.G.	22	20	18	16
AMP.	3	4	7	10
2. MAXIMUM ELECTRICAL RATING : 105°C 600 VOLTS MAX.
3. INSULATION MATERIAL : NYLON
4. INSULATION COLOR : RED
5. TERMINAL MATERIAL : BRASS
6. WIRE RANGE : 22-16 A.W.G.( 0.5-1.5 mm<sup>2</sup>)
7. TERMINALS SURFACE TREATMENT : TIN PLATED
8. DOUBLE CRIMP : WITH COPPER SLEEVE ON BARREL
9. NEMA TAB : 0.032 \* 0.250 (0.8 \* 6.35)
10. TERMINALS THICKNESS : 0.40 mm

Tolerance Unless Otherwise Specified		
0 > 6 mm	±0.20	ANGLE
6 > 18 mm	±0.30	0° > ° REF ±
18 > 30 mm	±0.40	° ±
30 > 75 mm	±0.50	° ±

NAME	NYLON-FULLY INSULATED DOUBLE CRIMP FEMALE DISCONNECTORS			UNIT	
PART NO.	11970	MATERIAL	-----	APPROVE	
NUMBER	.....	SCALE	SHEET	PAGE	CHECKED
DATE	2006/08/23	4/1	1-0	10F2	DRAWN

Morris Products Inc.