



Catalog Number 11976
UPC Number 60198611976
Description Nylon Fully Insulated Female Disconnect
16-14 AWG



Features

- Nylon Color Coded insulation for easy identification
- Manufactured from high strength copper alloy
- Electro-tin plated for corrosion resistance
- Expanded insulation eliminates strand “Hang Up”, provides strain relief & excellent UV, temperature and chemical resistance
- Wire range stamped on the surface for easy interpretation
- Brazed seams prevent splitting under maximum pressure
- Serrated barrel & extended crimp sleeve provides excellent electrical contact & pull-out force resistance

General

Insulation Type Nylon
Material Brass/Copper
Finish Electro-Tin Plated
Color Blue
Wire Range 16-14
Tab Size .250 X .032

Dimension Information

Stock Thickness 0.016
L Inches (mm) 0.846
B Inches (mm) 0.433
C Inches (mm) 0.091
D Inches (mm) 0.197
F Inches (mm) 0.287
W Inches (mm) 0.26

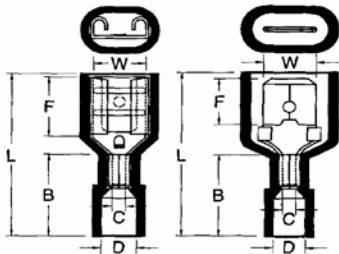

Specifications

Temperature Rating 105°C
Voltage Rating 600 V
Flammability Rating UL94V-O
Amp Rating 14 AWG 15 Amps
16 AWG 10 Amps

Packaging

Bag Qty 100
Master Bag Qty 1000

Certifications

UL Yes
cUL Yes
RoHS Yes

Morris Products 53 Carey Road, Queensbury, NY 12804

www.morrisproducts.com



REV	DESCRIPTION	DATE
-----	-------------	------

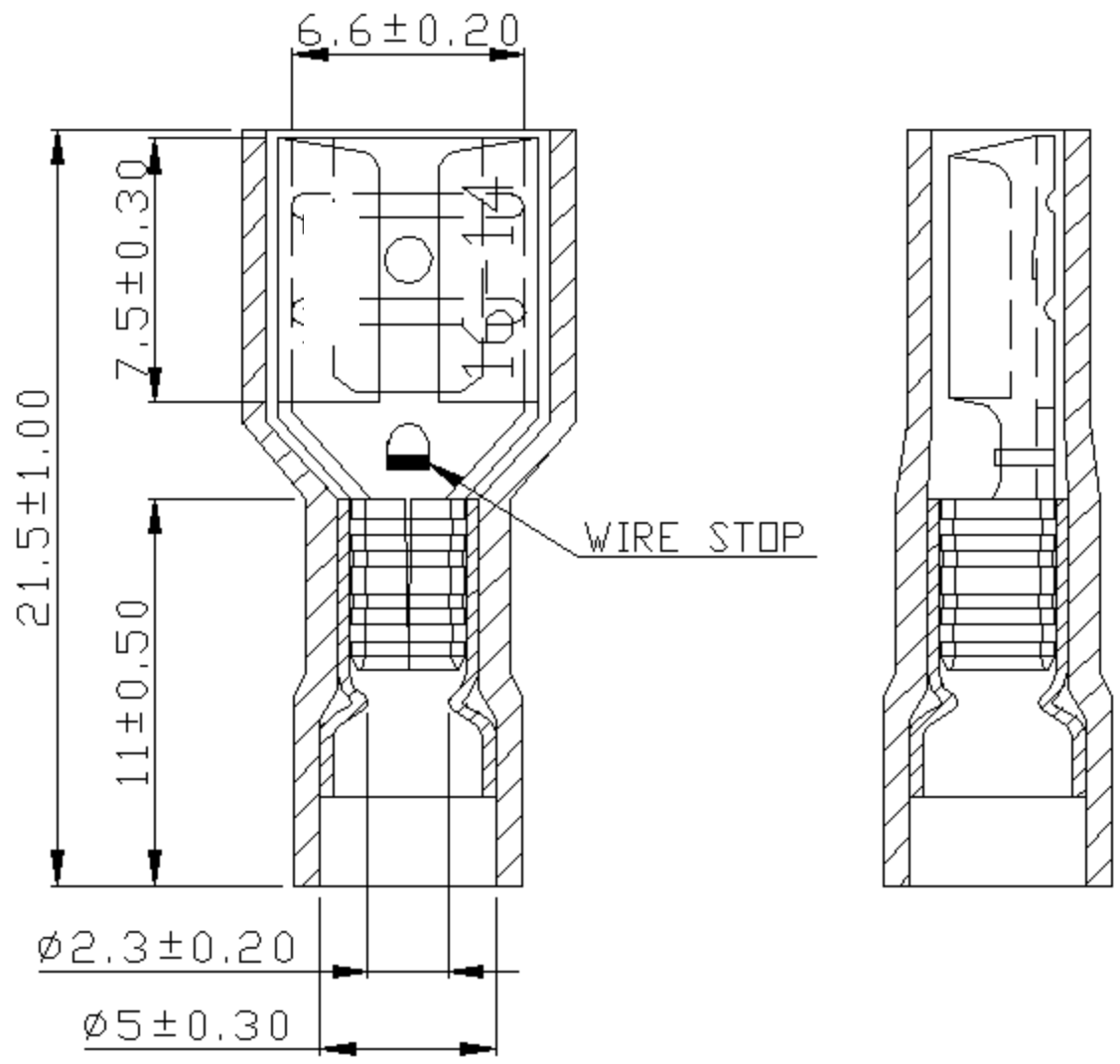

NOTE:

1. MAXIMUM ELECTRIC CURRENT :

A.W.G.	16	14	
AMP.	10	15	
2. MAXIMUM ELECTRICAL RATING : 105°C 600 VOLTS MAX.
3. INSULATION MATERIAL : NYLON
4. INSULATION COLOR : BLUE
5. TERMINAL MATERIAL : BRASS
6. WIRE RANGE : 16-14 A.W.G.(1.5-2.5 mm²)
7. TERMINALS SURFACE TREATMENT : TIN PLATED
8. DOUBLE CRIMP : WITH COPPER SLEEVE ON BARREL
9. NEMA TAB : 0.032 * 0.250 (0.8 * 6.35)
10. TERMINALS THICKNESS : 0.40 mm

Tolerance Unless Otherwise Specified			
0 > 6 mm	±0.20	ANGLE	
6 > 18 mm	±0.30	0°	REF ±
18 > 30 mm	±0.40	°	±
30 > 75 mm	±0.50	°	±

NAME	NYLON-FULLY INSULATED DOUBLE CRIMP FEMALE DISCONNECTORS				UNIT	mm	
PART NO.	11976	MATERIAL	-----	APPROVE			
NUMBER	SCALE	SHEET	PAGE	CHECKED		
DATE	2006/08/14	3/1	1-0	10F2	DRAWN		

Morris Products Inc.