

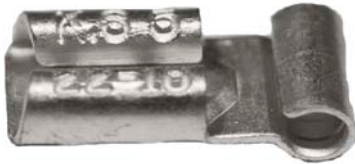

Catalog Number 12420
UPC Number 60198612420
Description Non Insulated
Right Angle Flag Female Disconnect
16-14 AWG

Features

- Manufactured from high strength copper alloy
- Electro-tin plated for corrosion resistance
- Wire range stamped on the surface for easy interpretation
- Brazed seams prevent splitting under maximum pressure
- Serrated barrel provides excellent electrical contact & pull-out force resistance



General

Insulation Type N/A
Material Brass
Finish Electro-Tin Plated
Color N/A
Wire Range 16-14
Tab Size .020 X .187

Dimension Information

Stock Thickness 0.016
L Inches (mm) 0.457
B Inches (mm) 0.217
F Inches (mm) 0.244
W Inches (mm) 0.197

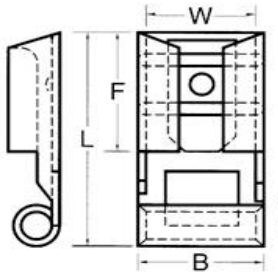

Specifications

Temperature Rating 150°C
Voltage Rating 300 V
Flammability Rating N/A
Amp Rating 14 AWG 15 Amps
16 AWG 10 Amps

Packaging

Bag Qty 100
Master Bag Qty 1000

Certifications

UL Yes
cUL Yes
RoHS Yes

Morris Products 53 Carey Road, Queensbury, NY 12804

www.morrisproducts.com



REV	DESCRIPTION	DATE
-----	-------------	------

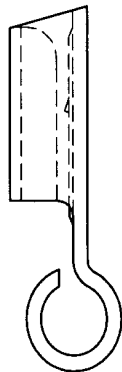
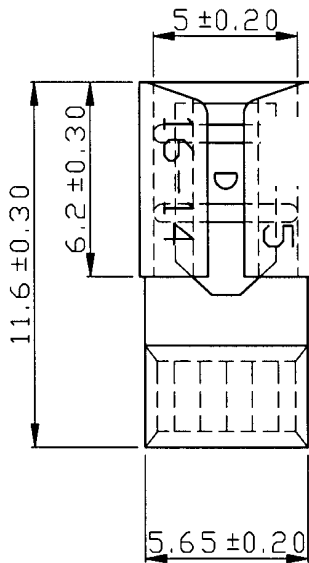
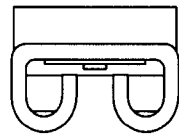

NOTE :

- MAXIMUM ELECTRIC CURRENT :

A.W.G.	16	14
AMP.	10	15
- WIRE RANGE : 16-14 A.W.G. (15-25 mm²)
- NEMA TAB : 0.020 inch * 0.187 inch (0.8 mm * 4.75 mm)
- SURFACE TREATMENT : TIN PLATED
- THICKNESS : 0.4 mm

Tolerance Unless Otherwise Specified	
0 > 6 mm ± 0.20	ANGLE
6 > 18 mm ± 0.30	0° > ° REF ±
18 > 30 mm ± 0.40	° > ° ±
30 > 75 mm ± 0.50	° > ° ±

NAME	NON-INSULATED FLAG FEMALE DISCONNECTORS(NORMAL TYPE)			UNIT	mm	
PART NO.	12420	MATERIAL	BRASS	APPROVE		
NUMBER		SCALE	SHEET PAGE	CHECKED		
DATE	2007/04/11	4/1	1-0 1 OF 2	DRAWN		

Morris Products Inc.