

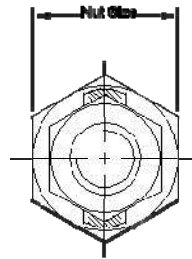

## Service Post Connectors

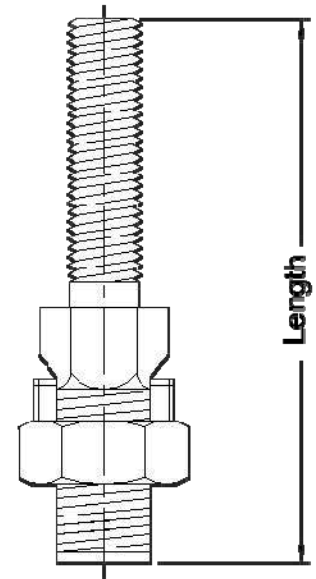

- Used to Ground One Wire to Steel Structures, Transformers, Fence Posts, Steel Bar, or Plate
- High Strength Electrolytic Copper
- UL 467 Listed for Direct Burial & Grounding/Bonding Applications in Earth or Concrete
- cULus Listed

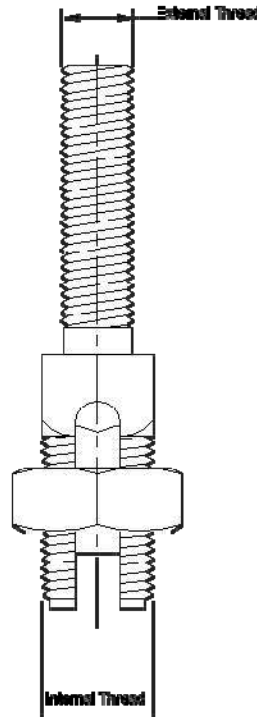

Part No.	Nut Size	Length	External Thread	Internal Thread	Conductor Size	
					Min	Max
90368	.37	1.69	1/4" x 20 UNC	3/8" x 24 UNF	14	8
90369	.43	1.89	1/4" x 20 UNC	7/16" x 20 UNF	8	6
90370	.5	1.95	5/16" x 18 UNC	1/2" x 20 UNF	10	4
90371	.56	2.19	3/8" x 16 UNC	9/16" x 18 UNF	10	2
90372	.68	2.21	1/2" x 13 UNC	1-1/6" x 16 UNF	8	1
90373	.75	2.59	1/2" x 13 UNC	3/4" x 16 UNF	4	2/0
90374	.87	2.69	1/2" x 13 UNC	7/8" x 14 UNF	2	3/0
90375	1.12	3.21	5/8" x 11 UNC	1-1/8" x 12 UNF	1	4/0